

# Installation Instructions

## Descriptions

The luminaire contains constant-current driver(s) and LED module(s). It works under technical conditions as the product labels indicate. Its modular design makes it convenient to replace whichever of the modules that failed.

## Technical Parameter

LED Flood Light					
Module Quantity	1	2	3	4	5
Power	60W	120W	180W	240W	300W
Input Voltage	<input type="checkbox"/> 100~240V <input type="checkbox"/> 100~277V <input type="checkbox"/> 220~240V <input type="checkbox"/> 120~277V <input type="checkbox"/> 277~480V <input type="checkbox"/> Other____				Frequency 50/60Hz
Power Factor	0.95				
Working Environment	-40°C~+50°C, 10%~90%RH				
Storage Environment	-40°C~+50°C, 10%~90%RH				
Bolt Torque	17Nm				
Mounting Height	0~35m				
Dimensions	150x300x335 mm	335x300x310mm	335x300x310 mm	375x300x310mm	455x300x310mm
Net Weight	2.3kg	3.9kg	4.6kg	5.4kg	6.4kg
Project Area	0.045m <sup>2</sup>	0.101m <sup>2</sup>	0.101m <sup>2</sup>	0.113m <sup>2</sup>	0.137m <sup>2</sup>
Degree of Protection	<input type="checkbox"/> IP54 <input type="checkbox"/> IP65 <input type="checkbox"/> IP66 <input type="checkbox"/> IP67 <input type="checkbox"/> Other____				

Notes: The above net weight is typical value. The power above are maximum rated power of the model subject to tolerance of 10%.

## Applications

Architectural exterior lighting for single building and historical complex; flood lighting on buildings; indoor area lighting; landscape lighting; billboard lighting; medical, cultural and other establishment lighting; bar, club and other atmosphere lighting; port, air port and other traffic and parking area lighting.

## Installation and Maintenance

### Installation

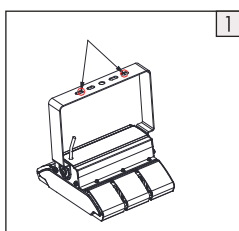

1. Fix the bracket onto the mounting surface with two screws. (recommend M10 screws)

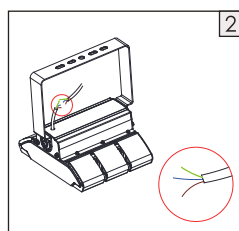

2. Connect the wires to the AC input (make sure it grounded sufficiently).

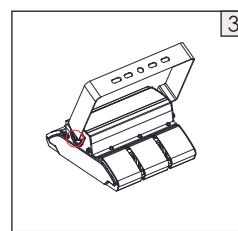

3. Loosen the M8x20 screws and adjust the mounting angle of the bracket, then tighten the screws up.

### Maintenance

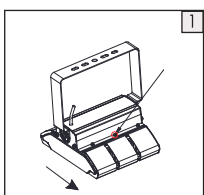

1. Loosen the two M4x12 screws, and slide the module out in the direction of the arrow.

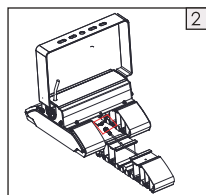

2. Disconnect the failed module from the connectors.

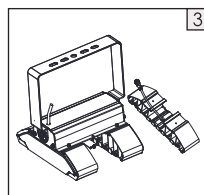

3. Take out the failed module.

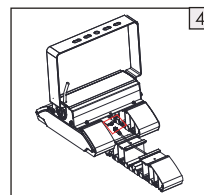

4. Replace the module with a new one, and tighten up the waterproof connectors.

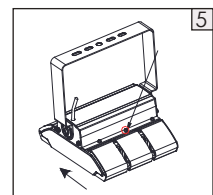

5. Slide the module in the direction of the arrow, fix it into the groove of main beam, and tighten up the two M4x12 screws.

# Installation Instructions

## Cable Connectors

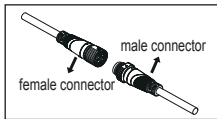

1. Connect the male and female connectors by aligning the indicative arrow on them.

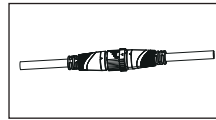

2. Hold the nut on one terminal still, meanwhile, rotating clockwise till the one on the other terminals is tightened up. Otherwise the waterproof performance might be affected.

## Wiring

Power Supply End	Earth wire	Neutral wire	Live wire
Fixture End	Yellow-green lead	Blue lead	Brown lead
	Green lead	White lead	Black lead

## Caution

- a** Disconnect or turn off power before installation, maintenance and wiring.
- b** Cable connection must be insulated and waterproof.
- c** The light source should be replaced by the manufacturer, its server agent, or someone similarly qualified.

Warning: Danger! Electric shock risk!

(via IEC 60417-6042 (2011-11) )



Minimum distance from the light source to the illuminated object: 0.1m.

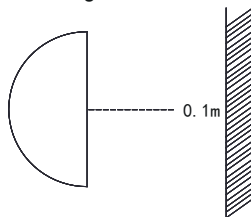

The luminaire shall be installed by a qualified electrician and wired in accordance with the latest IEE electrical regulations or the national requirements.



This marking indicates that this product should not be disposed with other household wastes throughout the EU. To prevent possible harm to the environment or human health from uncontrolled waste disposal, recycle it responsibly to promote the sustainable reuse of material resources. To return your used device, please use the return and collection systems or contact the retailer where the product was purchased. They can take this product for environmental safe recycling

## Remarks

1. This luminaire uses permanent connection on power supply with flexible cable and wires (60245 IEC57). Sufficient length of cable is reserved for connection to AC power. Protection over the connection joint and elimination of tensile force there should be ensured.
2. This luminaire uses type Z attachment: the external flexible cable or cord of this luminaire cannot be replaced; if the cord is damaged, the luminaire shall be destroyed.
3. Wiring: the connection to AC power should be operated on terminal blocks in a wiring box with a degree of protection at least equivalent to the luminaire, and there should be devices to fixate wires.
4. The luminaire can be mounted onto ordinary combustible surfaces.