

Installation Instructions

Descriptions

The luminaire contains constant-current driver(s) and LED module(s). It works under technical conditions as the product labels indicate. Its modular design makes it convenient to replace whichever of the modules that failed.

Technical Parameter

LED Street Light								
Module Quantity	1	2	3	4	5	6	7	
Power	60W	120W	180W	240W	300W	360W	420W	
Input Voltage	<input type="checkbox"/> 100~240V <input type="checkbox"/> 100~277V <input type="checkbox"/> 220~240V <input type="checkbox"/> 120~277V <input type="checkbox"/> 277~480V <input type="checkbox"/> Other____						Frequency	50/60Hz
Power Factor	0.95							
Working Environment	-40°C~+50°C, 10%~90%RH							
Bolt Torque	17Nm							
Mounting Height	6~15m							
Mounting Spacing	20~45m							
Dimensions	575x345x175mm	625x345x175mm	705x345x175mm	785x345x175mm	865x345x175mm	945x345x175mm	1025x345x175mm	
Net Weight	6.2kg	7.3kg	8.5kg	9.7kg	11.3kg	12.8kg	14.4kg	
Project Area	0.199m ²	0.216m ²	0.244m ²	0.271m ²	0.299m ²	0.327m ²	0.354m ²	
Degree of Protection	<input type="checkbox"/> IP54 <input type="checkbox"/> IP65 <input type="checkbox"/> IP66 <input type="checkbox"/> IP67 <input type="checkbox"/> Other____							

Notes: The above net weight is typical value. The power above are maximum rated power of the model subject to tolerance of 10%.

Applications

Expressway, highway, avenue, trunk road, sub-trunk road, path, parking lot, factory, schoolyard, garden, park, residential area, courtyard, etc.

Installation and Maintenance

Installation

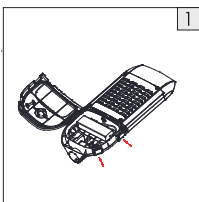

1. Undo the two buckles on the side to open the cover of electrical compartment.

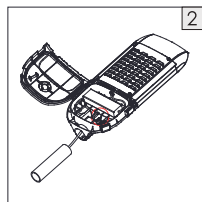

2. Thread the AC input cable through the hole in the installing tube. Connect the L, N, G wires to right positions on terminal block.

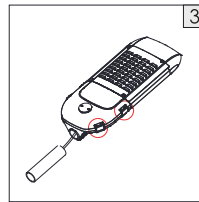

3. Close the cover and lock up the buckles.

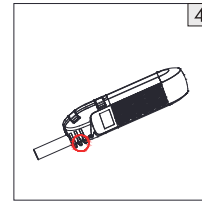

4. Insert pole arm into the installation tube, put the fixture straight, and tighten up the three screws on the tube.

Maintenance

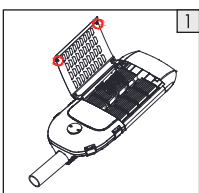

1. Undo the two hand screws to open the cover for light source compartment.

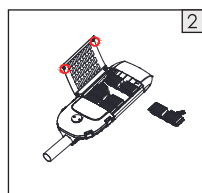

2. Undo the screws on both end of the module, and disconnect the module at cable.

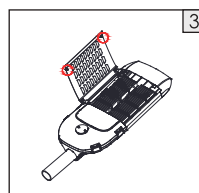

3. Take out the failed module and install a new one. Tighten up the screws and the cable connector.

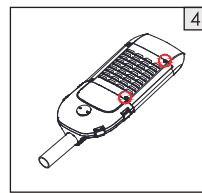

4. Close the cover and tighten up the hand screws.

Cable Connectors

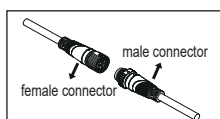

1. Connect the male and female connectors by aligning the indicative arrow on them.

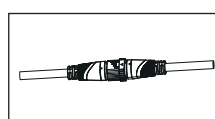

2. Hold the nut on one terminal still, meanwhile, rotating clockwise till the one on the other terminals is tightened up. Otherwise the waterproof performance might be affected.

Installation Instructions

Installation of NEMA Receptacle and Photocell

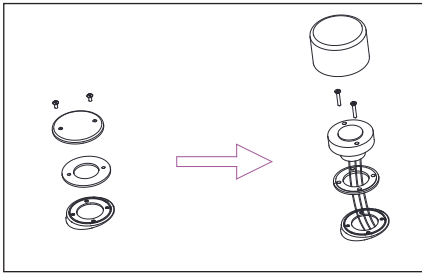

1. Undo the two screws to remove the round cover and its white sealing washer.
2. Thread the wires of the receptacle through the black sealing washer into the electrical compartment of luminaire. Keep the screw holes in alignment among the receptacle, sealing ring and luminaire, and fixate the receptacle with two M4x25 cross recessed countersunk head screws.
3. Plug in and fasten the photocell. Connect the wires in the electrical compartment.

Wiring

Power Supply End	Earth wire	Neutral wire	Live wire
Fixture End	Yellow-green lead	Blue lead	Brown lead
	Green lead	White lead	Black lead

Caution

- a** Disconnect or turn off power before installation, maintenance and wiring.
- b** Cable connection must be insulated and waterproof.
- c** For luminaires with glass cover: the cover is made of tempered glass which shatters into small pieces without sharp edges when it breaks. Application condition: -30°C~100°C; maximum temperature rise $\Delta t \leq 60^\circ\text{C}$.
- d** The light source of this luminaire is not replaceable. When the light source's lifetime comes to an end, it is the whole luminaire that should be replaced.

Warning: Danger! Electric shock risk!

(via IEC 60417-6042 (2011-11))



For luminaires with glass cover: The broken cover should be replaced.

Rectangle

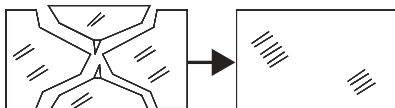

Round

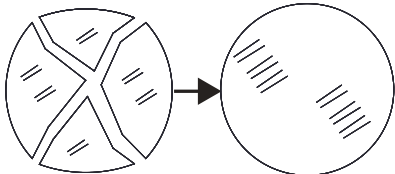

The luminaire shall be installed by a qualified electrician and wired in accordance with the latest IEE electrical regulations or the national requirements.



This marking indicates that this product should not be disposed with other household wastes throughout the EU. To prevent possible harm to the environment or human health from uncontrolled waste disposal, recycle it responsibly to promote the sustainable reuse of material resources. To return your used device, please use the return and collection systems or contact the retailer where the product was purchased. They can take this product for environmental safe recycling

Remarks

1. This luminaire uses permanent connection on power supply with flexible cable and wires (60245 IEC57). Sufficient length of cable is reserved for connection to AC power. Protection over the connection joint and elimination of tensile force there should be ensured.
2. This luminaire uses type Y attachment: method of attachment of the cable or cord such that any replacement can only be made by the manufacturer, his service agent or similarly qualified person.
3. Wiring: the connection to AC power should be operated on terminal blocks in a wiring box with a degree of protection at least equivalent to the luminaire, and there should be devices to fixate wires.
4. The luminaire can be mounted onto ordinary combustible surfaces.