

# Installation Instructions

## Descriptions

The luminaire contains constant-current driver(s) and LED module(s). It works under technical conditions as the product labels indicate. Its modular design makes it convenient to replace whichever of the modules that failed.

## Technical Parameter

LED Street Light					
Module Quantity	2	3	4	5	
Power	120W	180W	240W	300W	
Input Voltage	<input type="checkbox"/> 100~240V <input type="checkbox"/> 100~277V <input type="checkbox"/> 220~240V <input type="checkbox"/> 120~277V <input type="checkbox"/> 277~480V <input type="checkbox"/> Other____			Frequency	50/60Hz
Power Factor	0.95				
Working Environment	-40°C~+50°C, 10%~90%RH				
Bolt Torque	17Nm				
Mounting Height	6~15m				
Mounting Spacing	20~45m				
Dimensions	395x300x90mm	475x300x90mm	555x300x90mm	635x300x90mm	
Net Weight	5.0kg	5.8kg	6.6kg	7.6kg	
Project Area	0.119m <sup>2</sup>	0.143m <sup>2</sup>	0.167m <sup>2</sup>	0.197m <sup>2</sup>	
Degree of Protection	<input type="checkbox"/> IP54 <input type="checkbox"/> IP65 <input type="checkbox"/> IP66 <input type="checkbox"/> IP67 <input type="checkbox"/> Other____				

Notes: The above net weight is typical value. The power above are maximum rated power of the model subject to tolerance of 10%.

## Applications

Expressway, highway, avenue, trunk road, sub-trunk road, path, parking lot, factory, schoolyard, garden, park, residential area, courtyard, etc.

## Installation and Maintenance

### Installation

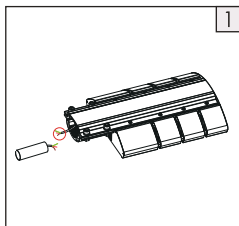

1. Connect the wires to L, N, and G of AC power input. Make sure it grounded sufficiently.

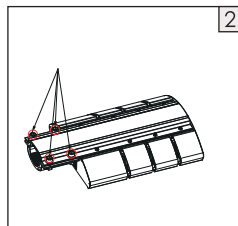

2. Loosen the four M10x45 hex mounting screws.

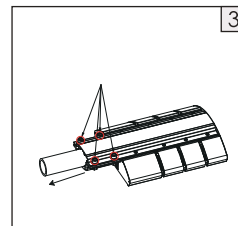

3. Mount the luminaire onto a pole. Tighten up the screws to fixate it.

### Maintenance

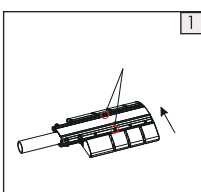

1. Undo the screws for the failed module. Slide it to the side in direction as the arrow points, and take it out.

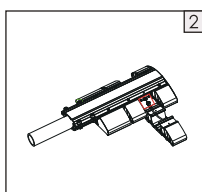

2. Disconnect its cable connectors.

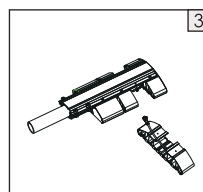

3. Replace with a new module.

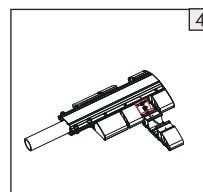

4. Connect the new module to the cable connector and tighten up.

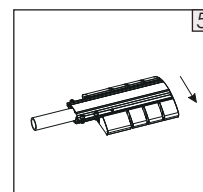

5. Draw the module in direction as the arrow points to hang on the beam at the groove.

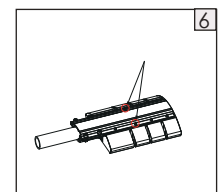

6. Fix the module with screws.

# Installation Instructions

## Cable Connectors

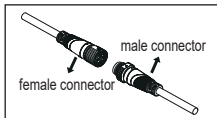

1. Connect the male and female connectors by aligning the indicative arrow on them.

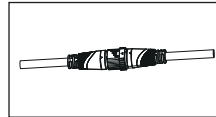

2. Hold the nut on one terminal still, meanwhile, rotating clockwise till the one on the other terminals is tightened up. Otherwise the waterproof performance might be affected.

## Wiring

Power Supply End	Earth wire	Neutral wire	Live wire
Fixture End	Yellow-green lead	Blue lead	Brown lead
	Green lead	White lead	Black lead

## Caution

- a** Disconnect or turn off power before installation, maintenance and wiring.
- b** Cable connection must be insulated and waterproof.
- c** For luminaires with glass cover: the cover is made of tempered glass which shatters into small pieces without sharp edges when it breaks. Application condition: -30°C~100°C; maximum temperature rise  $\Delta t 60^{\circ}\text{C}$ .
- d** The light source of this luminaire is not replaceable. When the light source's lifetime comes to an end, it is the whole luminaire that should be replaced.

Warning: Danger! Electric shock risk!

(via IEC 60417-6042 (2011-11) )



For luminaires with glass cover: The broken cover should be replaced.

Rectangle

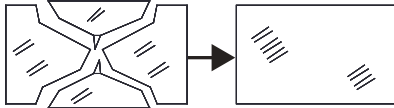

Round

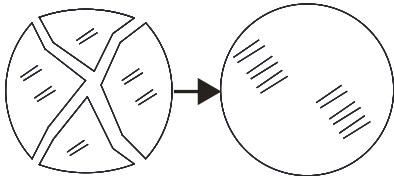

The luminaire shall be installed by a qualified electrician and wired in accordance with the latest IEE electrical regulations or the national requirements.



This marking indicates that this product should not be disposed with other household wastes throughout the EU. To prevent possible harm to the environment or human health from uncontrolled waste disposal, recycle it responsibly to promote the sustainable reuse of material resources. To return your used device, please use the return and collection systems or contact the retailer where the product was purchased. They can take this product for environmental safe recycling

## Remarks

1. This luminaire uses permanent connection on power supply with flexible cable and wires (60245 IEC57). Sufficient length of cable is reserved for connection to AC power. Protection over the connection joint and elimination of tensile force there should be ensured.
2. This luminaire uses type Z attachment: the external flexible cable or cord of this luminaire cannot be replaced; if the cord is damaged, the luminaire shall be destroyed.
3. Wiring: the connection to AC power should be operated on terminal blocks in a wiring box with a degree of protection at least equivalent to the luminaire, and there should be devices to fixate wires.
4. The luminaire can be mounted onto ordinary combustible surfaces.